

MACRAME

GOES MODERN



Give this classic craft a timely twist and glam up your walls with a bit of bling

Big in the 70s, macramé is making a comeback! Forget the plant holders of the past, these projects take the idea of the knotted wall hanging a step further and throw in a few materials from the hardware store. The result? A glam work of art, created by you!



SHARE THE LOVE

Show off your finished *Better Homes and Gardens* projects! Upload photos to Instagram (tag #bhgaus and the handle @bhgaus) or Facebook via bhg-showusyours.com.au

JOINED TEE FITTINGS



1 SO SIMPLE, SO EYE-CATCHING! Who knew balsa wood - used in model making - and copper plumbing fittings could look so designer? It's a winning combo in a neutral colour scheme.

EASY STEPS TO COPPER ART



STEP 2

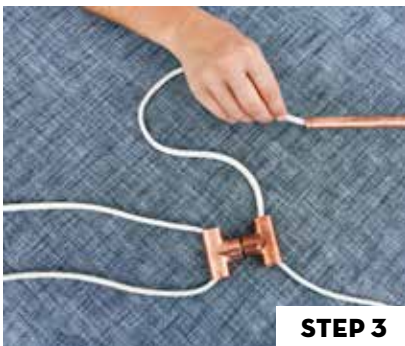

STEP 3



STEP 4



STEP 6



STEP 7



STEP 8

Gather your supplies

- Copper pipe
- Copper coil
- Copper tee fitting
- Macramé cord
- Balsa sheets
- Copper wire

You'll also need

Pipe cutter; scissors; wire snips; utility knife

You can create any design you like for your wall art. Work out the lengths to cut copper pipes and follow these steps to learn how to join the pipes and balsa sheets using cord and wire.

FOR YOU TO NOTE

Factor in that balsa sheets are 915mm long and 75 or 100mm wide

“ Your macramé masterpieces are wall jewellery you can use to dress up bedrooms and hallways ”

when creating your design. To make longer pieces, join them end to end.

Here's how

STEP 1 Cut copper pipe to length and coil to size with pipe cutters. Assemble all the components on a flat surface to check the design.

STEP 2 Thread 2 copper tee fittings onto 2 lengths of macramé cord to join them together.

STEP 3 To hang a pipe from the joined tees, run the cords from one end through a length of copper pipe.

STEP 4 Make holes in balsa sheets in the corners using a utility knife. Use copper wire to join 2 sheets together, length to length or end to end.

STEP 5 Thread copper pipe and coil onto macramé cord, the ends

will be part of the woven rope at the top of the wall art.

STEP 6 Join balsa panels to pipes and coils with copper wire, looping and knotting to secure.

STEP 7 Use wire to hang pipes parallel from those threaded onto cord.

STEP 8 Gather all the macramé cords at the top and plait several strands at a time to make a hanger for the wall art. Tie off and tuck the ends under to hang from a hook, rated to take the wall art's weight.

Stockists

Bunnings Haron 32mm hose and pipe cutter, \$12.90. Kembla 13mm x 3m copper tube, \$20.99. Kinetic 15 x 15 x 15mm copper capillary tee, \$1.15. Decor8 marble mosaic tile, \$24.80. Kinetic threaded brass pipe 15 x 300mm, \$16.77. Balsawood sheets. Spotlight Macramé cord off-white 6mm x 50m, \$50. Macramé cord off-white 3mm x 50m, \$30. Leather thonging in natural 3mm x 10m, \$20. Designer copper wire 20-gauge, \$9/10m.

DESIGN YOUR OWN WALL HANGING

Threaded
pipe and
mosaic tiles



2 MACRAMÉ MEETS MOSAIC ART with this wall hanging - it's a bit of a cross between a mobile and a dreamcatcher! The concept is the same - thread and tie all the elements together to create a wall hanging. It uses threaded brass pipe instead of straight lengths. And for more texture, leather thonging not macramé cord. The balsa is painted to inject colour while marble mosaic tiles add another shape to the design. ■

